

## Grand Stands:

Flat screen monitors are becoming a standard in the office. Replacing a large CRT monitor with a 3" deep LCD flat screen creates a huge space saving on the desk top. However, the space savings is behind the screen. Our variety of Flat Screen Supports not only free up valuable desk space but also give you an infinite number of placement options.



### 8725MA Short Mini Flex Arm

- Die-cast aluminum in black finish
- Tilt - pivot only
- Wall mount only; bracket included

List: . . . . . **140.00**

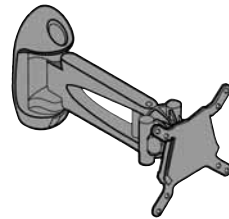

### 8750MA Mini Flex Arm

- Die-cast aluminum in black finish
- Tilt - pivot only
- Wall mount only; bracket included

List: . . . . . **150.00**

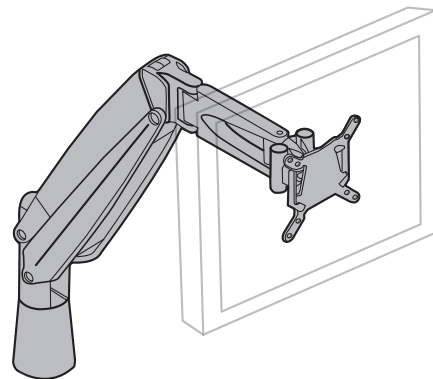

### 8700MA Deluxe Flex Arm

- Die-cast aluminum in black finish only
- Height and focal distance adjustment
- Extends 23" from mounting point
- Supports monitors from 2 - 10 lbs. or 11 - 25 lbs.; please specify
- All mounts included: clamp, grommet, wall mount and through desk mount; please specify

List: . . . . . **385.00**

### METRO Monitor Arm

- Die-cast aluminum in silver finish
- 6" Integral gas-spring height adjustment (from 13" to 19")
- Extends 18" from mounting point
- Supports monitors from 2 - 17 lbs. or 17 - 33 lbs.; please specify
- Monitor quick-release feature
- Standard desk clamp / wall mount, optional grommet mount; please specify

#### 8650MA-SD for 2 - 17 lb screens

List: . . . . . **360.00**

#### 8650MA-HD for 17 - 33 lb screens

List: . . . . . **390.00**

#### 8652MS-HD Dual Metro Monitor Arm

- Supports two monitors up to 33 lbs. total
- Standard desk clamp, optional grommet mount; please specify

List: . . . . . **550.00**

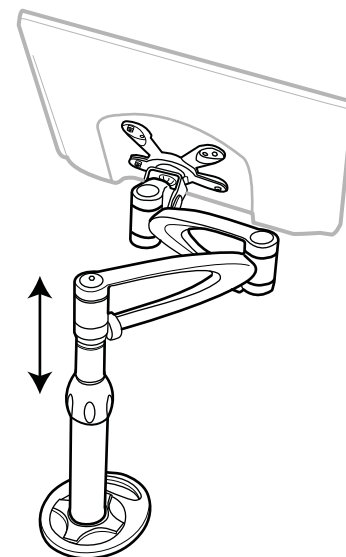

## Flat Screen Monitor Supports

### NOVA Flat Screen Arm

- Light weight aluminum construction, silver finish
- Gas spring for effortless positioning
- 23" extended reach and 17" height adjustment allows user to sit or stand
- Monitor quick-release feature
- Cable management system
- Standard Clamp Mount; grommet available on request
- Available in standard (SD) and heavy duty (HD) for larger monitors

#### 8890MA-SD for 6 - 15 lb. Screens (15", 17")

List: . . . . . **430.00**

#### 8890MA-HD for 17½ to 33 lb. screens (19" +)

List: . . . . . **475.00**

### 8892MS-HD Dual NOVA Flat Screen Arm

- Heavy Duty Articulating Arm with gas assisted spring
- Holds two 17" or 19" screens, up to 33 lbs. total
- Standard desk clamp, optional grommet mount, please specify

List: . . . . . **599.00**

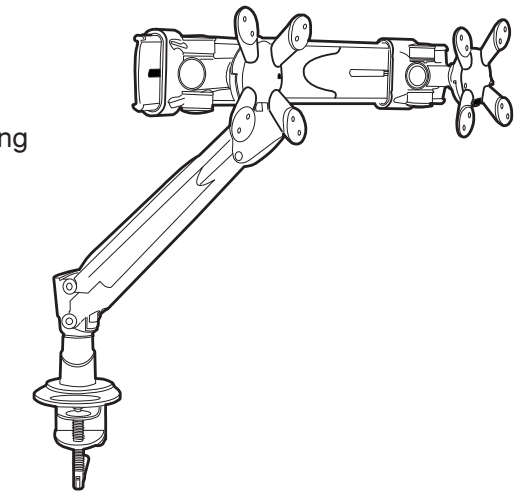
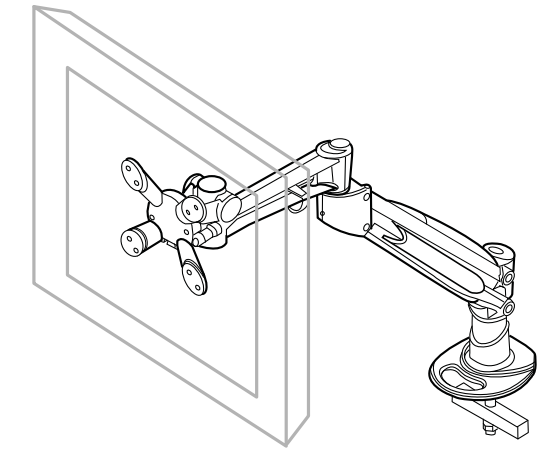

### ERGOFlex Arm - Flat Screen Monitor Support

- Offers three points of articulation.
- 19" Front to back focal adjustment and side to side movement
- 16" vertical post provides 13" of height range; (Quad has 27½" pole)
- Available in silver only
- Clamp is standard, optional grommet mount available; specify

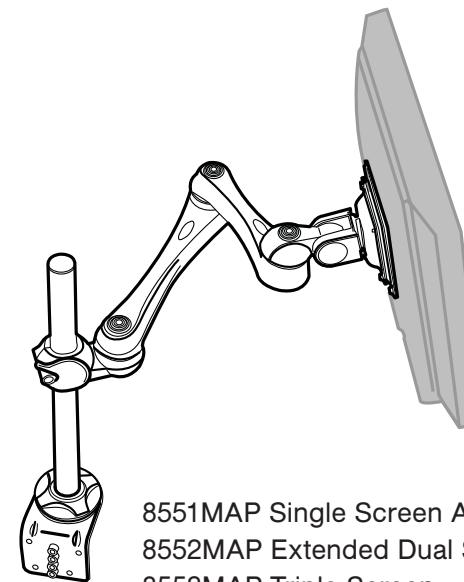

#### 8551MAP Single Screen Arm

List: . . . . . **320.00**

#### 8552MAP Extended Dual Screen

List: . . . . . **470.00**

#### 8553MAP Triple Screen

List: . . . . . **560.00**

#### 8554MAP Quad Screen

List: . . . . . **790.00**

