

A SERIES

SIT AND STAND



Grand Stands

Ergonomic Workstation Solutions

Since 1991 - Pioneers, Designers & Manufacturers of the Finest Custom Ergonomic Solutions

Installation

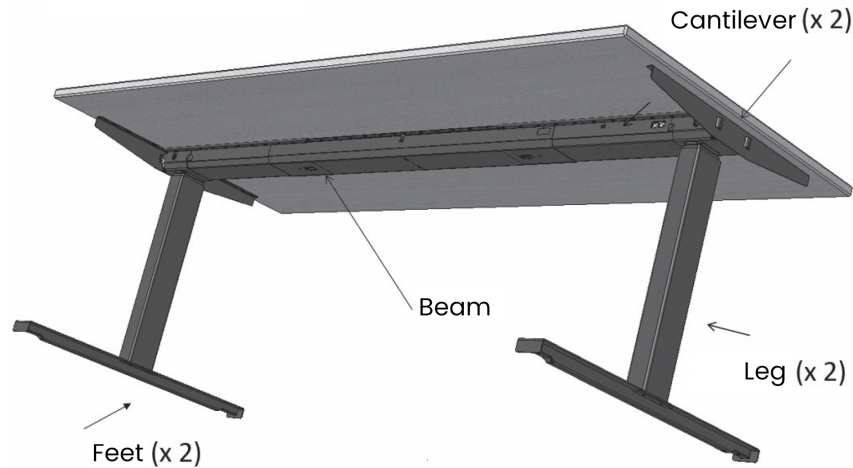

Parts

1. Gather all parts for the desk including the tabletop.

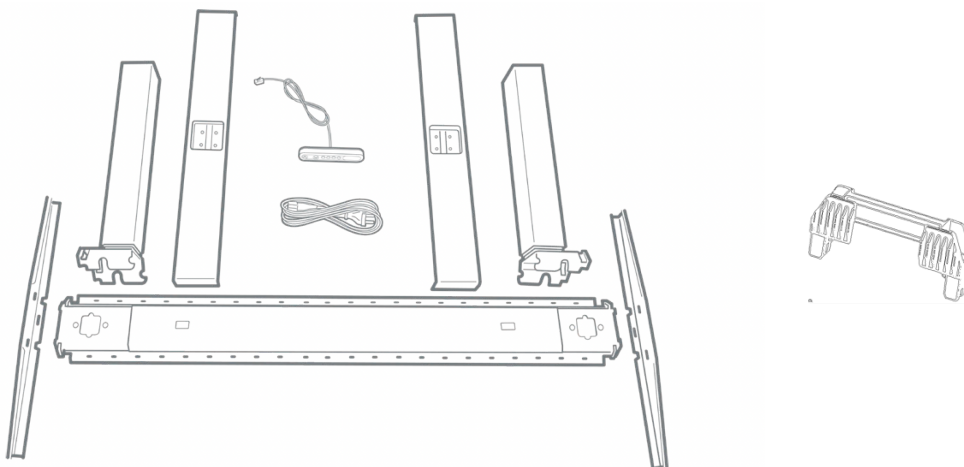

- (1) pc Expandable Beam
- (2) pcs Side Cantilevers
- (2) pcs Snap-on Lifting Columns 2 pcs Snap-on Feet
- (1) pc Power Cable
- (1) pc Control Switch 1 pc Hardware Pack
- (1) pc Lifting Column Removal tool

2. Turn the tabletop upside down.

3. Fix the beam length.

3.1. Extend the beam to the required length (1150 mm to 1750 mm (45" to 69"), adjustable in 50 mm (2") steps).

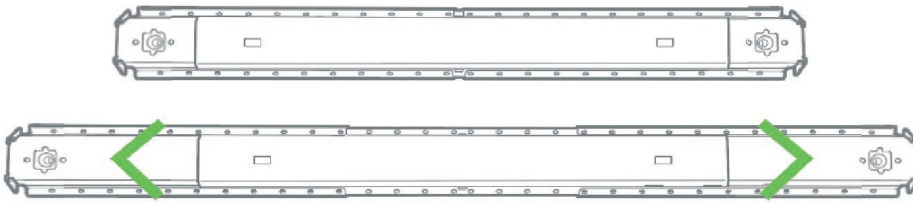

4. Mount the cantilevers.

4.1. Place a cantilever slightly tilted at the end of the beam.

4.2. Press the cantilever into place until a click is heard and the snap joint locks the cantilever in the correct position.

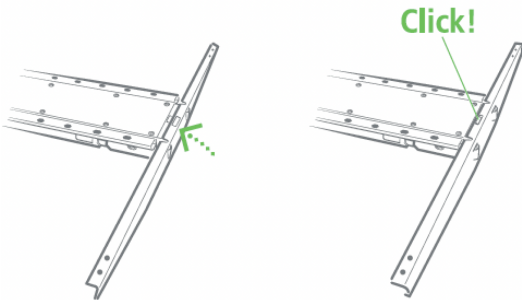

4.3. Mount the cantilever in the other end of the beam.

5. Place the assembled A-Series frame in the correct position. Use a tape measure to ensure central placement of the DF2 frame.

6. Fasten the A-Series frame to the tabletop using 20 mounting screws as follows:

6.a. 8 screws at the ends of the beam.

Use one of these to fix the mains cable to the beam with a cable clamp creating a cable relief, see step 9.
Connect power cable.

6.b. 4 screws at the extension points.

6.c. 8 screws in the cantilevers.

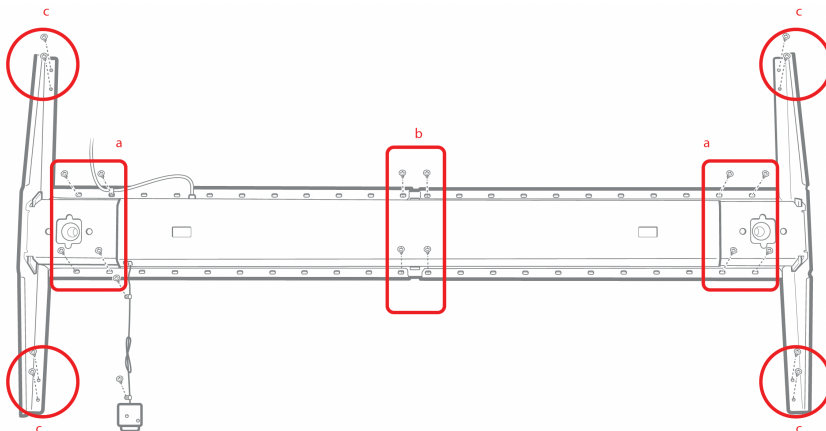

7. Mount the columns.

7.1. Ensure that the columns are completely retracted.

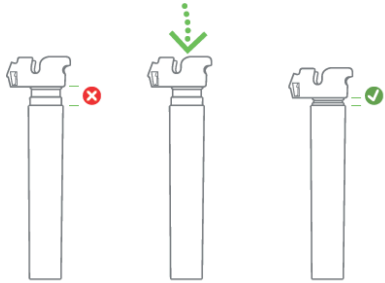

7.2. Tilt the columns and place them correctly on the beam using the guiding notches.

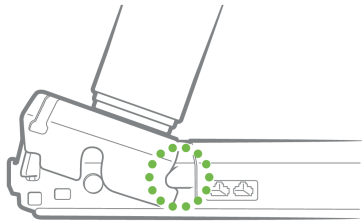

7.3. Fix the column to the beam by pressing down until a “click” is heard and **both** pawls lock the column in the correct position.

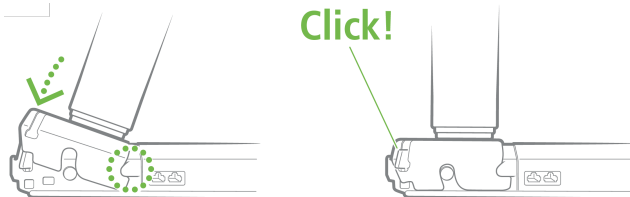

8. Mount the desk panel

8.1. Connect the desk panel in one of the RJ45 sockets.

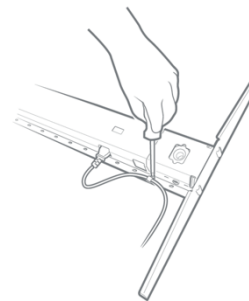
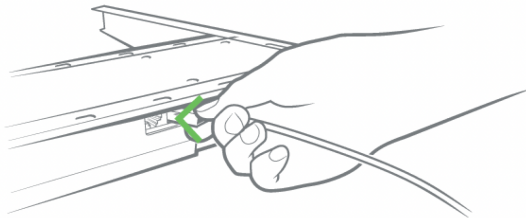

8.2. Fasten the desk panel to the tabletop using the mounting screws.

8.3. Fasten the cable to the tabletop using two screws and two cable clamps.

9. Connect the power cable.

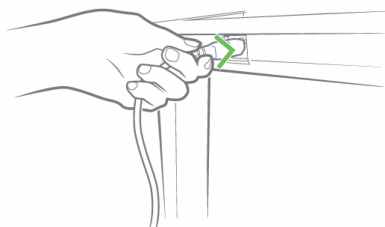

Ensure to make a cable relief using the cable clamp when fastening the cable to the tabletop.

10. Mount the feet

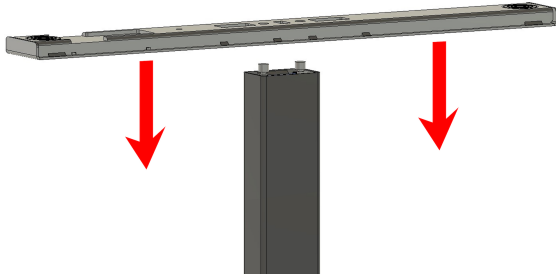

Important information

Important information on GRAND STANDS products can be found under the following headings:



Warning!

Failure to comply with these instructions may result in accidents involving serious personal injury.



Failing to follow these instructions can result in the product being damaged or being destroyed.



Important safety instruction

General

Safe use of the system is possible only when the operating instructions are read completely and the instructions contained are strictly observed.

Failure to comply with instructions marked with the "NOTE" symbol may result in serious damage to the system or one of its components.

Read all instructions before using this product.

DANGER - To reduce risk of electric shock:

- Always unplug this product from the electrical outlet before cleaning or servicing.
- **WARNING** - To reduce the risk of burns, fire, electric shock, or injury to persons:
Unplug from outlet before putting on or taking off parts.



It is important for everyone who is to connect, install, or use the systems to have the necessary information and access to this User Manual. Follow the instructions for mounting – there is a risk of injury if these instructions are not followed.



Close supervision is necessary when this product is used by or near children, invalids or disabled persons.



If there is visible damage to the product, do not install or use it.

Ensure that the cord and the plug are not damaged, and keep the cord away from heated surfaces.



Please note that during construction of applications in which the system is to be fitted, there must be no possibility of personal injury, for example squeezing of fingers or arms.



Never insert any object into any opening.



Assure free space for movement of the application in both directions to avoid blockage.

Intended use:

This product is intended for use indoors in household and commercial usage areas. Do not use outdoors.

Before installation, re-installation, cleaning, or troubleshooting:

- Stop the frame.
- Switch off the power supply and pull out the mains plug.
- Relieve the frame of any loads, which may be released during the work.
- Review the assembly instructions to confirm that the appropriate critical components and accessories are being used with this product.

Before start-up:

- Make sure that the system has been installed as instructed in this User Manual describing the motor system.
- Make sure that the voltage of the control box is correct before connecting the system to the mains.
- Always use the supplied mains cable.
- System connection. The individual parts must be connected before connecting the control box to the mains. See the User Manual for LINAK actuators, if necessary

During operation

- If the control box makes unusual noise or smells, switch off the mains voltage immediately.
- The maximum total load on the frame is 160 kg equally loaded, i.e. 80 kg on each column. The 160 kg include the tabletop.
- Duty Cycle: 5 %, Max. 1 min./19 min. pause
- Take care that the cables are not damaged.
- Unplug the mains cable on mobile equipment before moving it.
- The products must only be used in an environment, that corresponds to their IP protection.

Servicing of double-insulated products

In a double-insulated product, two systems of insulation are provided instead of grounding. No grounding means is provided on a double-insulated product, nor is a means for grounding to be added to the product. Servicing a double-insulated product requires extreme care and knowledge of the system, and is to be done only by qualified service personnel. Replacement parts for a double-insulated product must be identical to the parts they replace. A double-insulated product is marked with the words "Double insulation" or "Double insulated." The symbol (square within a square)  is also able to be marked on the product.

Repairs

In order to avoid the risk of malfunction, all A-Series repairs must only be carried out by authorized GRAND STANDS workshops or repairers, as special tools must be used and special gaskets must be fitted. Lifting units under warranty must also be returned to authorized GRAND STANDS workshops.

**Warning!**

If any of the A-Series products are opened, there will be a risk of subsequent malfunction.

**Warning!**

The A-Series systems do not withstand cutting oil.

Save these instructions.