

ATTENTION : ADDENDUM TO STEP 6.

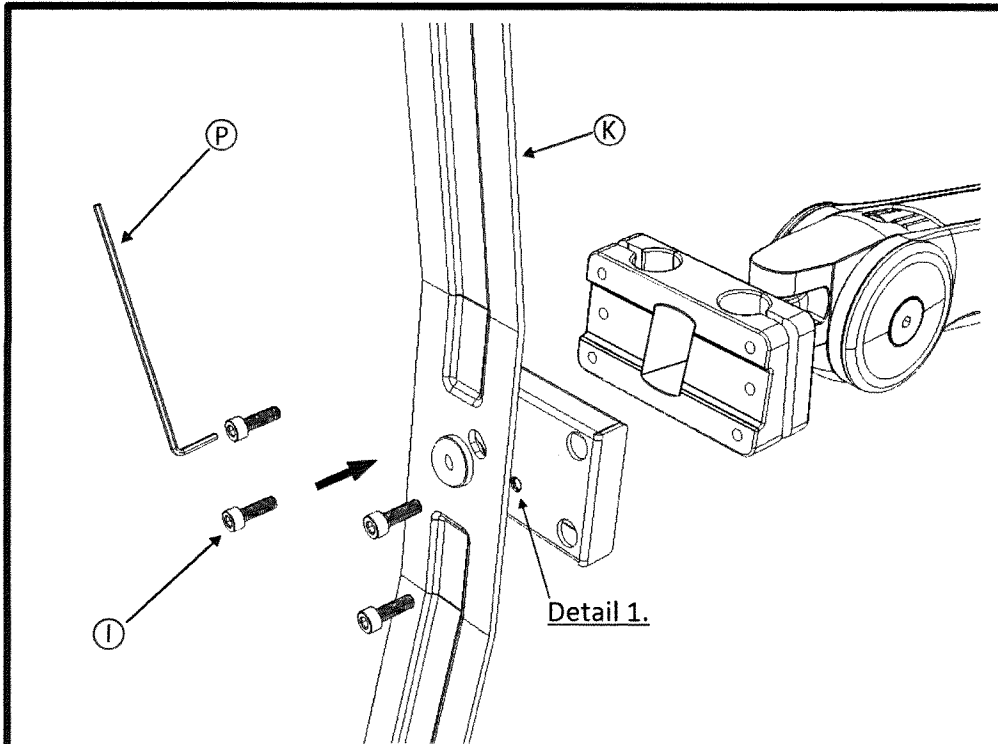

Step 6:
Fasten Spanner Bar Assembly to Mounting Bracket.
Swivel the spanner bar 90° to access the four corner holes in the Spanner Bar Assembly. Ensure the threaded hole in the Spanner Bar Assembly is located at the lower right corner upon assembly. (see Detail 1. for reference)

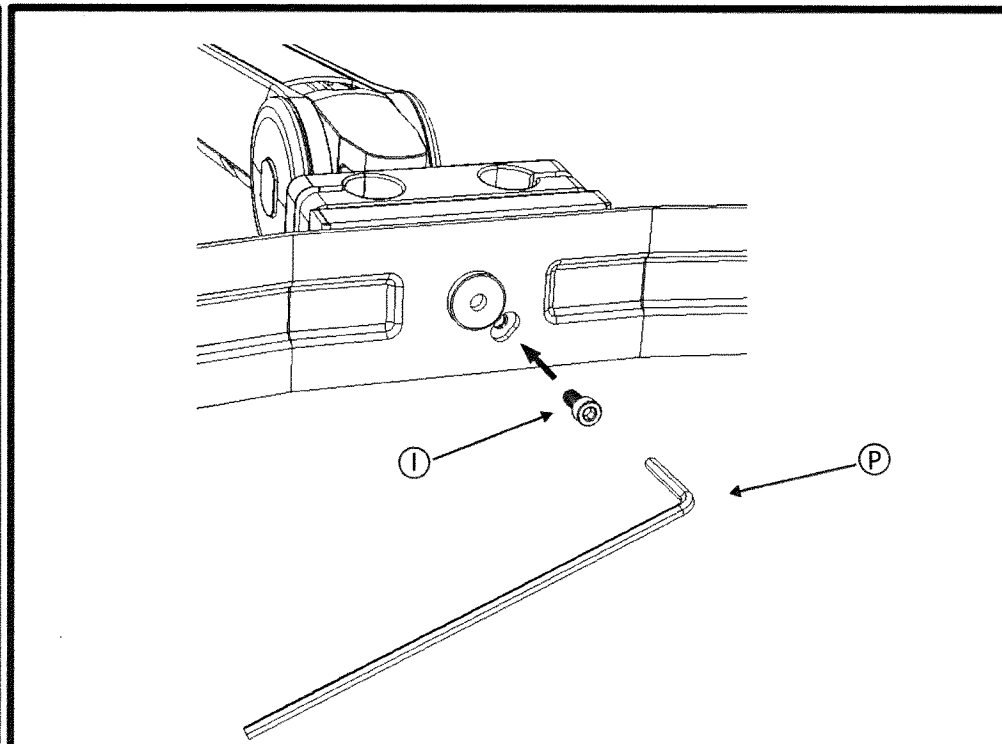

Step 6.1
Swivel the spanner bar back to 0° to access the swivel-lock threads.
Screw the additional M5 Hex Socket Screw (I) through the oval slot in the spanner bar. Tighten down as needed.